

Door Kits & Components

Ordering Guideline

Shelf-to-Deck

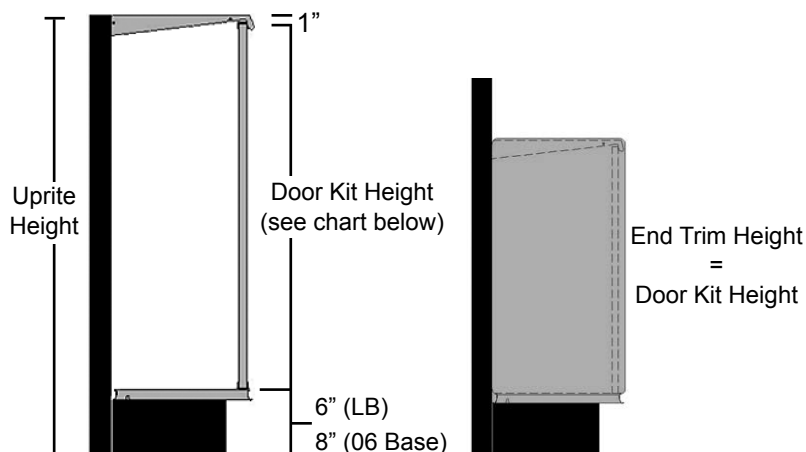

Shelf-to-Shelf

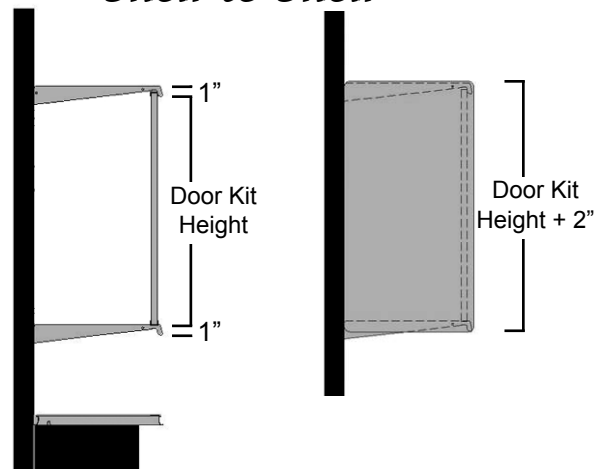

Full Height Application Chart		
UPRITE HEIGHT	BASE HEIGHT	DOOR KIT HEIGHT
54"	06	45"
54"	LB	47"
60"	06	51"
60"	LB	53"
66"	06	57"
72"	06	63"
72"	LB	65"
84"	06	75"
84"	LB	77"
96"	06	87"

LWS-to-Deck

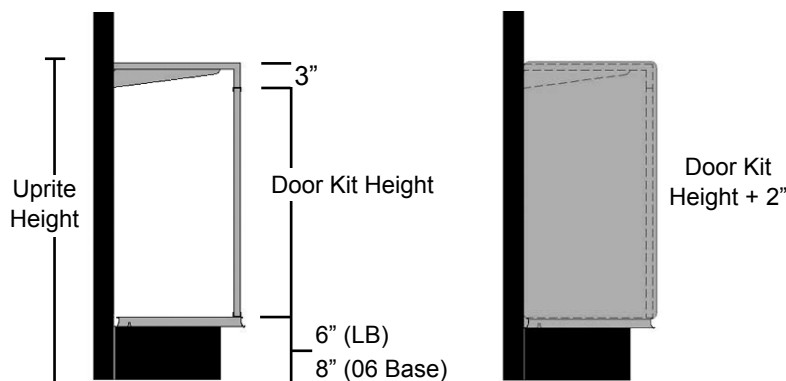

Door Kit Gap Filler:

- Fills void between top of Door Kit Frame & Bottom of upper shelf
- Recommended for Door Kits installed on 22"D or deeper shelf-to-deck applications
- Not required on shelf-to-shelf or Laminated Wood shelf-to-deck applications
- **For pricing see section 200, pg 26**

Door Kit Gap Filler



For Wiregrid Door Kits

EXAMPLE PART NO.

WGDKGF 4

STANDARD FINISH:

PLT

WGDKGF = Wiregrid Door Kit Gap Filler • Optional Tier I & II colors
4 = Length: 3' or 4"

For Glass or Hardboard Door Kits

EXAMPLE PART NO.

DKGF 4

STANDARD FINISH:

SAT

DKGF = Door Kit Gap Filler • Satin
4 = Length: 3' or 4"