

Tubular Face Out Arms:

- 1/2" x 1 1/2" rectangular tubing
- 2" back plate
- Two Styles:
12" Straight
12" 7-Ball Downslant
- **For pricing see section 400, pg 16**

STYLE	PART NO.
Straight	SWAS12
7-Ball Downslant	SWA7BD12

STANDARD FINISH:

PCP

- Polished Chrome plated

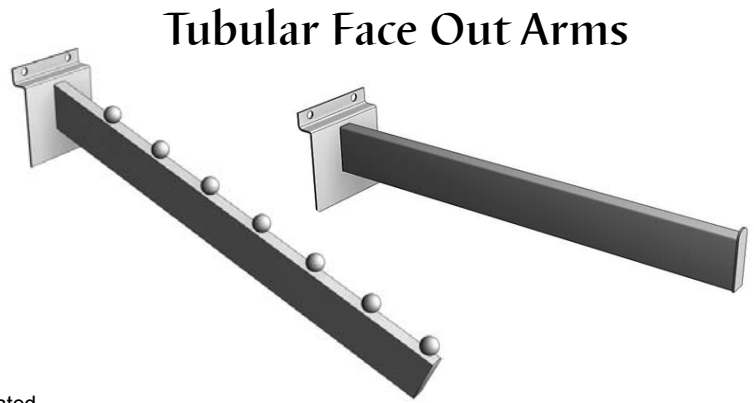

Tubular Face Out Arms

Shelf Bracket:

- Use for 12" glass, acrylic or wood shelves
- 2" back plate
- **For pricing see section 400, pg 16**

PART NO.
SWSB12

STANDARD FINISH:

PCP

- Polished Chrome plated

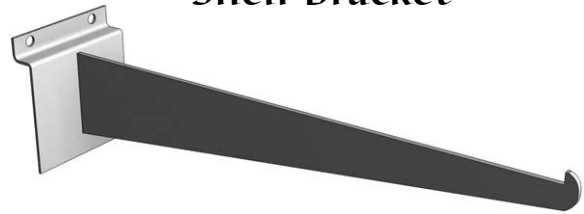

Shelf Bracket

Light Duty Display Hooks:

- .177 dia. wire, 1" back plate
- **For pricing see section 400, pg 16**

EXAMPLE PART NO.

SWSH 01

STANDARD FINISH:

PCP

SWSH = Slotwall Safety Hook
01 = Projection: 1", 4", 6", 9"

- Polished Chrome plated

Light Duty Display Hook



Display Hook:

- 3/8" dia. rod with 1" dia. disk end
- 12" long, 2" back plate
- **For pricing see section 400, pg 16**

PART NO.
HM2111

STANDARD FINISH:

PCP

- Polished Chrome plated

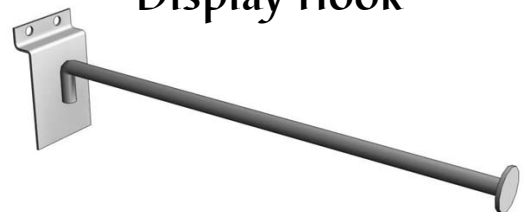

Display Hook

Flat Shoe Shelf:

- Clear acrylic construction
- **For pricing see section 400, pg 16**

WIDTH	DEPTH	PART NO.
10"	4"	HM1821

STANDARD FINISH:

XA5

- Clear acrylic

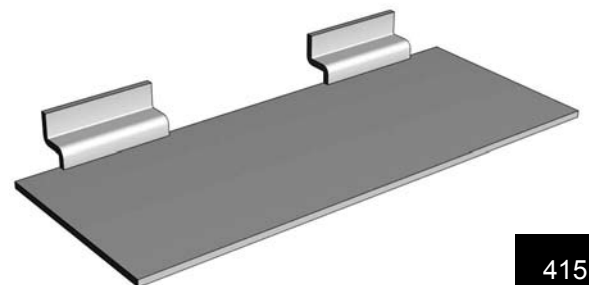

Flat Shoe Shelf